

Package Contains:

Shield and hardware pack. (6 Expandable Fasteners)

Tools Needed:

Soap, Water, Sponge, Tape Measure

Installation Instructions

Read these instructions carefully and completely before starting.

A. Preparation to install shield.

Clean hood of vehicle with hot soapy water, rinse and dry thoroughly.

If back painting of shield is desired, see Painting Instructions.

B. Shield Installation

Align slotted holes in hood shield with pre-existing mounting holes in under side of hood. **figure 1**

Note: Some hoods may have two rubber bumpers in the outer mounting holes, if so, remove and discard.

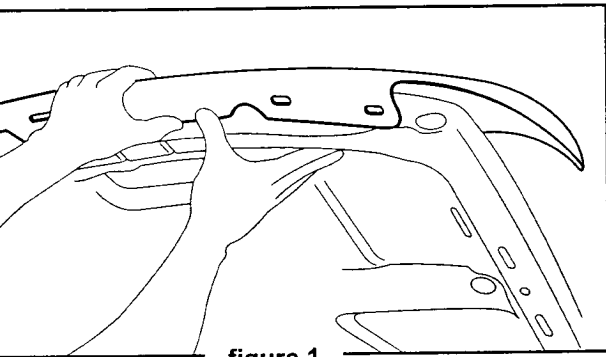

figure 1

Starting with the middle slots, insert an expandable fastener through hood shield and into hood. Press the head of the fastener halfway into its base. **figure 2**

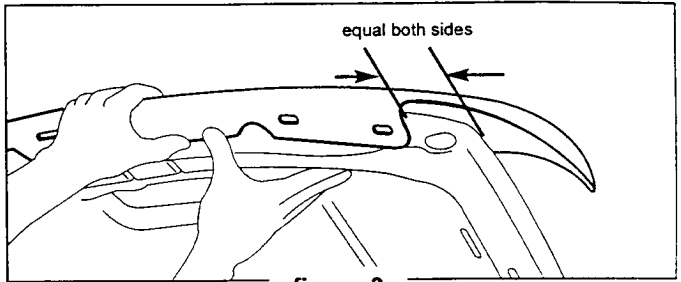
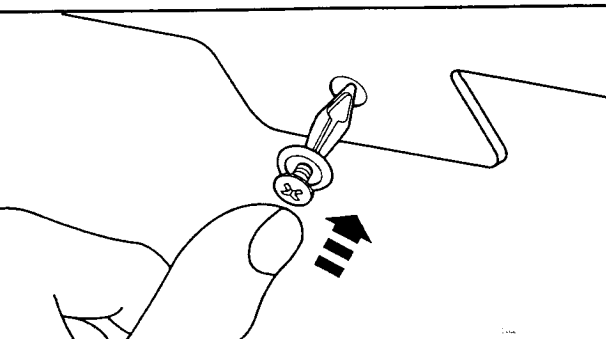

figure 3

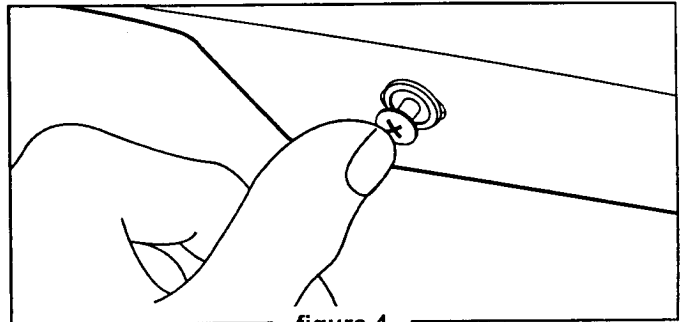

figure 4

6. Insert remaining fasteners and press each threaded plug fully into its base. **figure 4**

NOTE: To remove fasteners, unscrew threaded plunger and lift out remaining portion from hole. **figure 5**

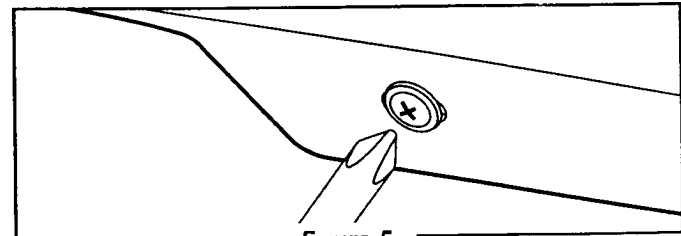

figure 5

Care & Cleaning

1. Avoid the use of automatic "brush-style" car washes.
2. Do not use cleaning solvents of any kind.

Painting Lexan and Acrylic Bug Shields

READ ALL INSTRUCTIONS CAREFULLY AND COMPLETELY BEFORE STARTING PROCEDURE. CHECK FIT BEFORE PAINTING. LUND WILL NOT WARRANT PAINTING COSTS ON MISFITTING SHIELDS.

Preparation

DO NOT USE SOLVENT CLEANERS OF ANY KIND TO CLEAN THE SHIELD. THIS WILL DAMAGE THE SHIELD

When preparing the shield for painting, be sure to work on a soft clean surface to ensure the shield will not be scratched.

The shield needs to be washed thoroughly using a mild liquid dish soap (without grit) and a soft clean cloth.

Rinse all traces of soap off with clean water.

Dry with a soft clean cotton cloth.

Warning: DO NOT leave any water or soap streaks on the inside of the shield.

Mask off the outside face of the shield with masking tape.

Trim the tape flush with the outer edge of the shield.

Clean out the inside surface again making sure that there is no streaks, finger prints, or imperfections, because paint will not hide these imperfections.

DO NOT sand or scuff the inside of the shield before painting. The solvents in the paint will adhere to the plastic.

Painting the Shield

DO NOT USE ACRYLIC LACQUER. The harsh solvents will cause crazing (hair-line cracks in the plastic).

Use only the following paints:

Epoxy Based Paints

-Lexon PC by Dupont

-Epoxy by Martin Senour

-Senour -Startthane by PPG

-Startthane by R-M

Urethane Based Paints

-Chromabase by Dupont

-TEC/Base by Martin Senour

-Deltron by PPG

-Solo by R-M

Acrylic Enamel Based Paints

-Centari by Dupont

-Acrylic Enamel by Martin

-Delstar by PPG

-Miracryl 11 by R-M

Warning: Light coats and dry times are a must to prevent crazing.

Mix Paint

Spray 1 light dry coat and let dry 10 minutes

Spray 1 light dry coat and let dry 10 minutes

Spray 1 wet coat and let dry 10 minutes

Spray 1 wet coat and let dry 10 minutes

Apply 1 final wet coat

Warning: Some metallic paints will appear to be translucent. If the color is translucent you will need to spray a layer of non-metallic paint of similar color after the metallic paint. Then cover the layer of non-