

STAMPEDE™

AUTOMOTIVE ACCESSORIES

For proper installation and best possible fit, please read all instructions BEFORE you begin.
For technical assistance or to obtain missing parts, please call Customer Relations at 1-800-241-7219.

Important Safety Information



- Serious personal injury and property damage can occur if vehicle is driven without both black snaps at the front of cover fastened.
- Prior to vehicle operation, clamps must be secured such that the clamp lips tightly grip the inner bedwall structure.
- Only release front strap/snap when fully installing cover.
- After a setting period (1 week) it may be necessary to readjust the clamp load after foam isolators take a set to maintain the uniform gap between the Tri-Fold Tonneau cover and bed rails.
- Check the bracket clamp loads every 3 months or 5,000 miles.
- The Tri-Fold Tonneau cover must be closed or secured with straps while the vehicle is in motion.

Installation Steps

NOTE: Actual application may vary slightly from illustrations.

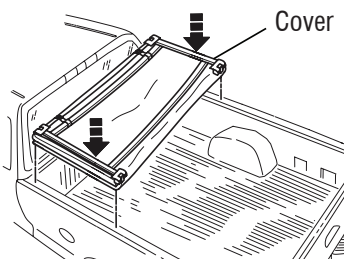

Place the cover assembly on the top of the truck bed next to the cab.
NOTE: Possible need for foam in some applications.

1

The cover has retaining straps with quick release snaps to keep it from being damaged when bulk hauling or when it is not on the vehicle.

The cover has retaining straps with quick-release snaps to keep it from being damaged when folded and vehicle is moving, bulk hauling, or when removed from vehicle.

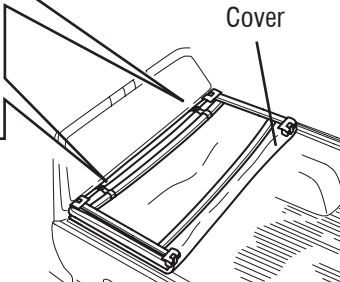
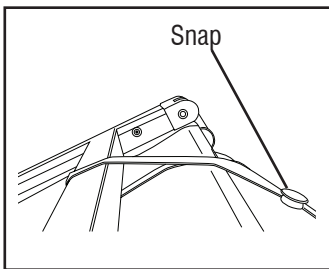

2

Adjust clamps to proper height. Make sure that the inner bed-wall structure and clamp lid are aligned as shown by dashed line. Handle height should be adjusted, such that, the clamp contacts the bed rail flange while the handle is in the 4 o'clock (LH) or 8 o'clock (RH) position.

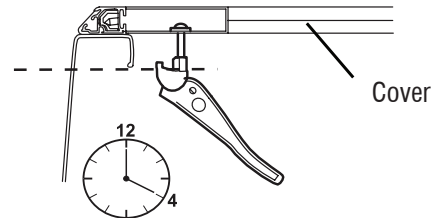

• Raise to Tighten (up)

• Lower to Loosen (down)

3

The retaining straps must be snapped when vehicle is in motion if Tonneau is in the folded position.

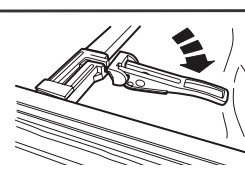
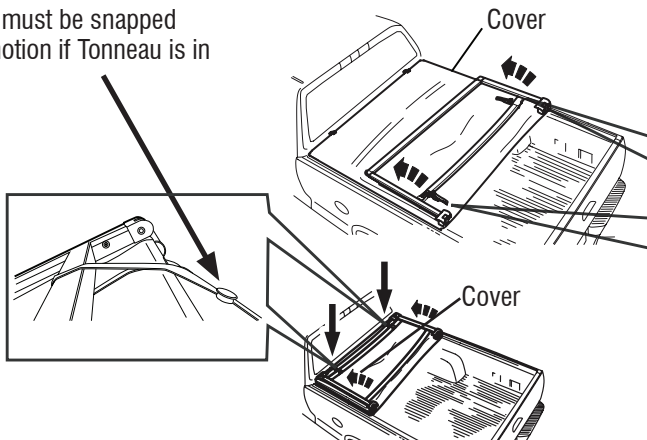

When stowing cover, position clamps in their storage positions or latch handles may puncture cover and void warranty.

4